



## Rear Lights

### General information

With the exception of the back-up lights, the rear light housings cannot be disassembled. The back-up light function takes place via conventional bulbs that can be replaced separately. The remaining lighting is provided by Light Emitting Diodes (LEDs).

If LEDs are malfunctioning, replace entire rear light assembly.

Rear light function can be checked using Vehicle Electrical System Control Module J519 On Board Diagnostic (OBD) program function "Output Diagnostic Test Mode (DTM)" ⇒ [97-6, Vehicle Electrical System Control Module J519 , Output Diagnostic Test Mode \(DTM\)](#) .

Before troubleshooting or servicing, technicians must be familiar with the functions and operation specifics of the standard or optional headlamp or lighting system. Always read the owners manual and review applicable system functions.

### **Note:**

- *Additional information:*

⇒ *Owners Manual*

⇒ *Self Study Program - Course Number 891503 "The 2006 Passat Introduction"*

⇒ *Self Study Program - Course Number 871503 "The 2006 Passat Electrical Systems Design and Function"*

⇒ *Electrical Wiring Diagrams, Troubleshooting and Component Locations binder*

CAN-Bus wire repairs ⇒ [97-8, Repairing CAN-Bus wires](#)

### **On Board Diagnostic, function**

Vehicle electrical system control is equipped with On Board Diagnostics (OBD) capabilities which assists in troubleshooting rear lights.

In the event of LED malfunction, replace entire rear light assembly.

For troubleshooting, use Vehicle Diagnostic, Testing and

Information System VAS 5051/5052 in operating mode  
"Guided Fault Finding" ⇒ [97-1, VAS 5051 / 5052](#) .

## Rear lights in rear fenders - Sedan, servicing

### Rear lights in rear fenders, component overview

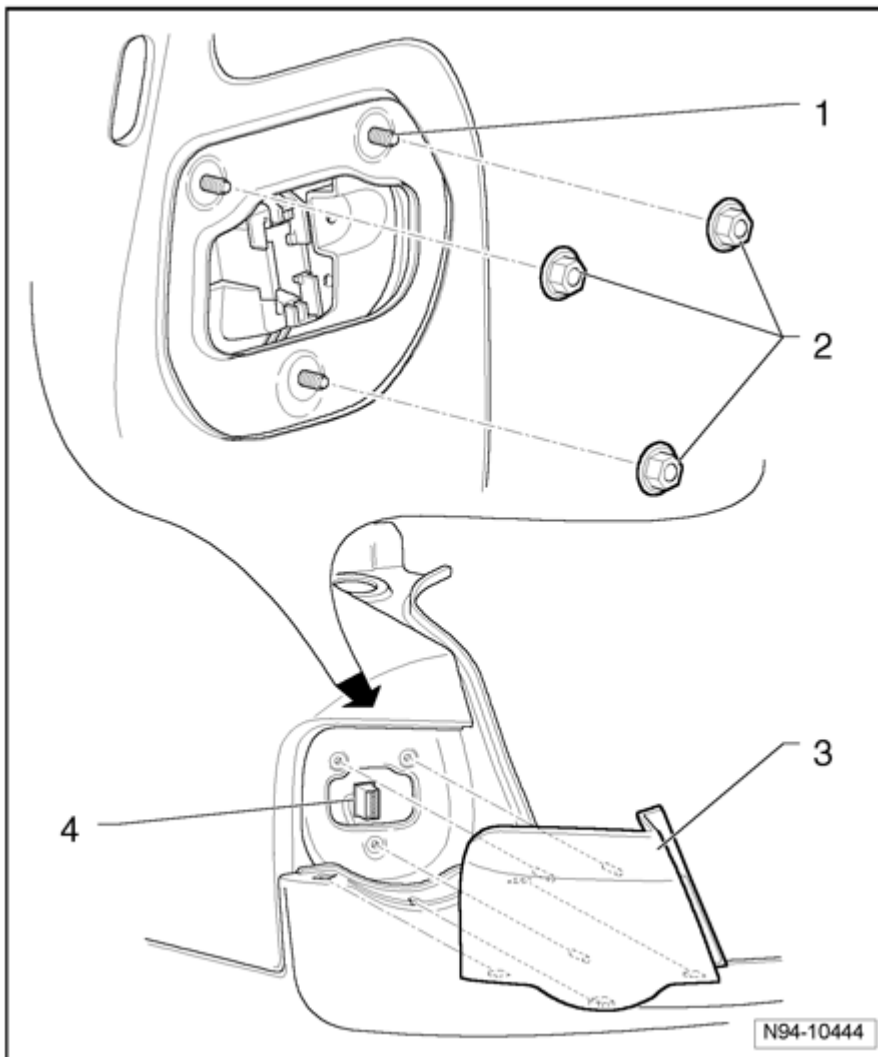

**1 - Threaded studs (on rear light housing)**

**2 - Nuts**

- Tightening torque ⇒ [94-12, Rear lights in rear fender side panels - Sedan, tightening torques](#)

**3 - Rear light in rear fender**

- Removing and installing ⇒ [94-6, Rear lights in rear fenders, removing and installing](#)
- Checking ⇒ [94-6, Rear lights in](#)

[rear fenders, checking](#)

#### 4 - Rear light housing electrical connection

##### Rear lights in rear fenders, removing and installing

Rear light housing in rear fender cannot be dismantled.  
The following components are integrated:

- Left Taillamp M4 and Right Taillamp M2
- Left Brake Lamp M9 and Right Brake Lamp M10
- Left Rear Turn Signal Lamp M6 and Right Rear Turn Signal Lamp M8

##### Special tools, testers and auxiliary items required

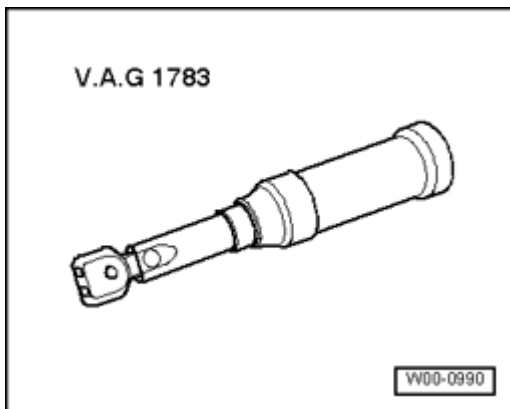

- Torque Wrench (5-60 Nm) VAG 1783 (or equivalent)

##### Removing:

##### Note:

- *The following illustrations depict removal and installation on left side. Removal and installation on right side is the same.*

##### Caution!

- **Switch off all electrical consumers.**
- **Switch ignition off and remove ignition key.**

- **Leave remote control ignition key in passenger compartment in order to prevent accidental door locking and automatic headlamp "Coming home/leaving home" activation.**

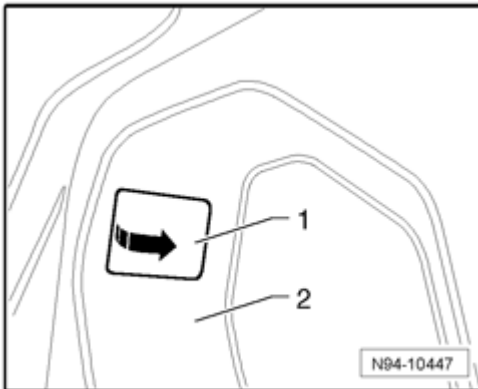

- Unclip cover - **1** - in direction of arrow from side panel - **2** - .

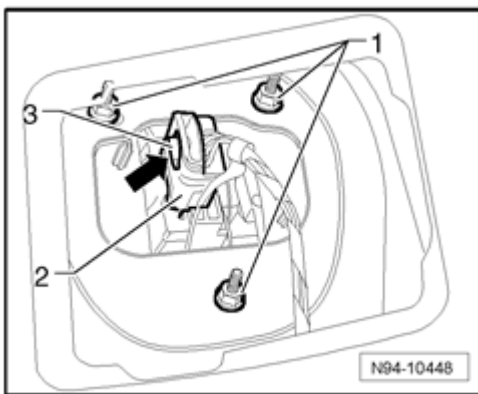

- Release electrical connection - **2** - by pulling locking tab
- **3** - in direction of arrow, and pull off of rear light housing.
- Remove nuts - **1** - and remove rear light housing from fender opening.

### **Installing:**

Install in reverse order of removal, noting the following:

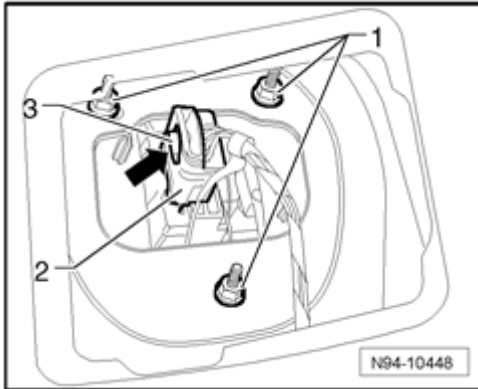

- Tighten nuts - **3** - according to value in table ⇒ [94-12, Rear lights in rear fender side panels - Sedan, tightening torques](#) .

**Note:**

- *Electrical connection - **2** - must be heard to engage "audibly" when reconnecting.*
- *Connection is properly connected when locking tab - **3** - is fully engaged.*

**Rear lights in rear fenders, checking**

Left Taillamp M4 , Right Taillamp M2 , Left Brake Lamp M9 , Right Brake Lamp M10 , Left Rear Turn Signal Lamp M6 , Right Rear Turn Signal Lamp M8 function can be checked using Vehicle Electrical System Control Module J519 On Board Diagnostic (OBD) program function "Output Diagnostic Test Mode (DTM)" ⇒ [97-6, Vehicle Electrical System Control Module J519 , Output Diagnostic Test Mode \(DTM\)](#) .

**Rear lights in rear lid - Sedan, servicing**

**Rear lights in rear lid, component overview**

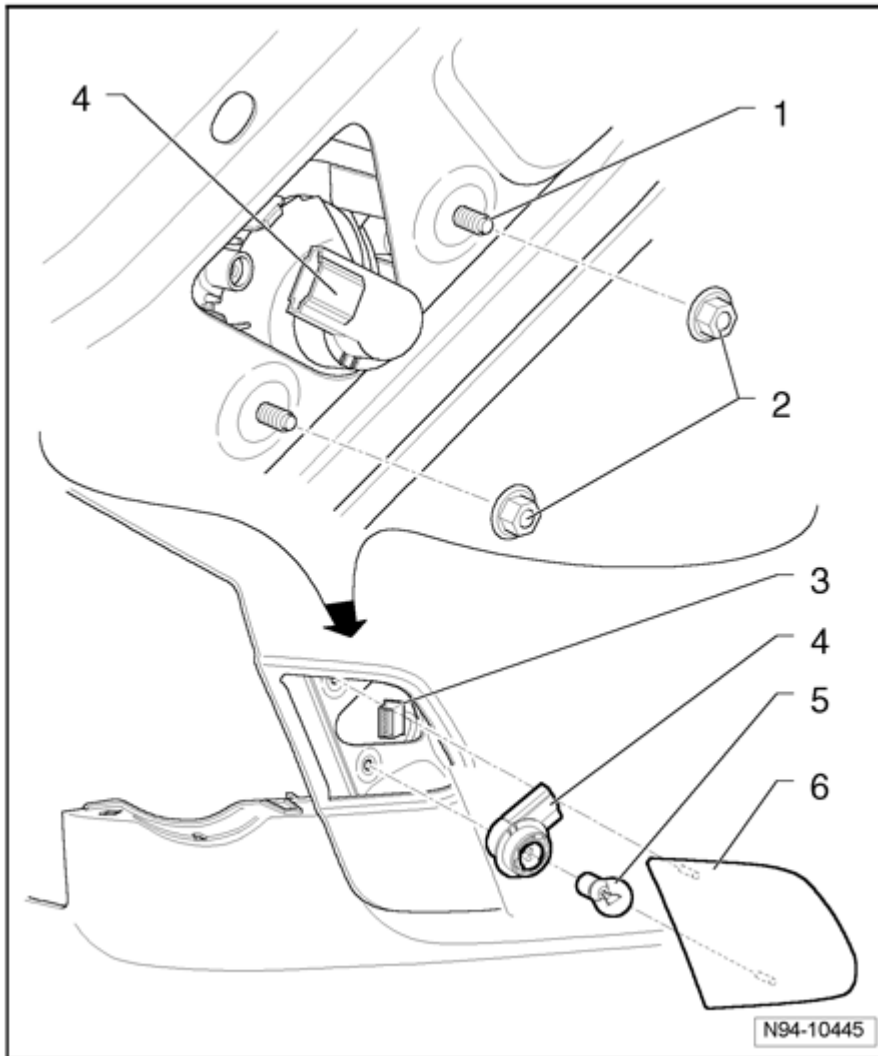

**1 - Threaded studs (on rear light housing)**

**2 - Nuts**

- Tightening torque ⇒ [94-12, Rear lights in rear lid - Sedan, tightening torques:](#)

**3 - Rear light in rear lid electrical connection**

**4 - Bulb holder**

- Removing and installing ⇒ [94-6, Rear lights in rear lid - bulb holder, removing and installing](#)

**5 - Left Back-Up Lamp M16 or Right Back-Up Lamp M17**

- 12 V, P 21 W

- Checking ⇒ [94-6, Rear lights in rear lid, checking](#)

## 6 - Rear light housing

- Removing and installing ⇒ [94-6, Rear lights in rear lid, removing and installing](#)

### Rear lights in rear lid, removing and installing

#### Special tools, testers and auxiliary items required

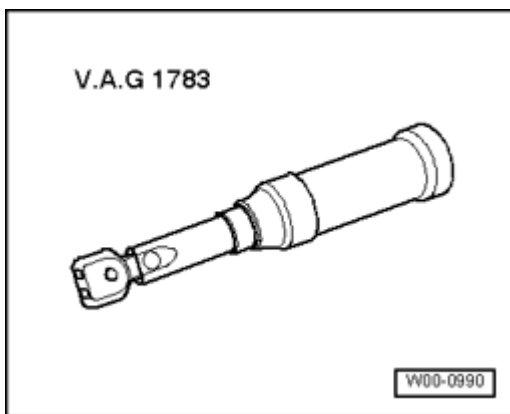

- Torque Wrench (5-60 Nm) VAG 1783 (or equivalent)

#### **Note:**

- *The following illustrations depict removal and installation on left side. Removal and installation on right side is the same.*

#### **Removing:**

#### **Caution!**

- **Switch off all electrical consumers.**
- **Switch ignition off and remove ignition key.**

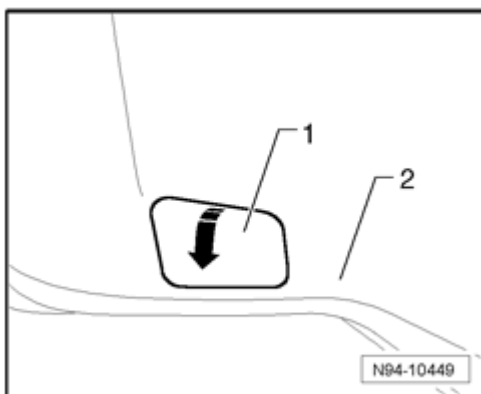

- Unclip cover - **1** - in direction of - **arrow** - from panel - **2**
- .

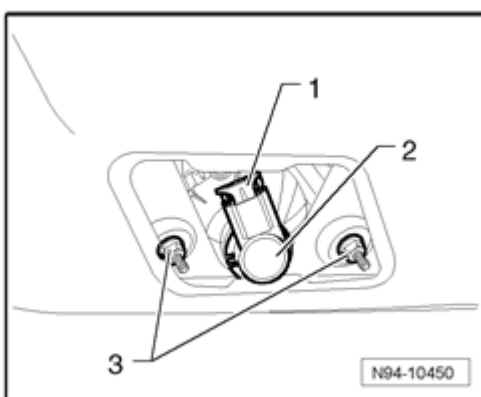

- Disconnect electrical connection - **1** - and remove from bulb holder - **2** - .
- Remove both nuts - **3** - .
- Remove rear lights from rear lid.

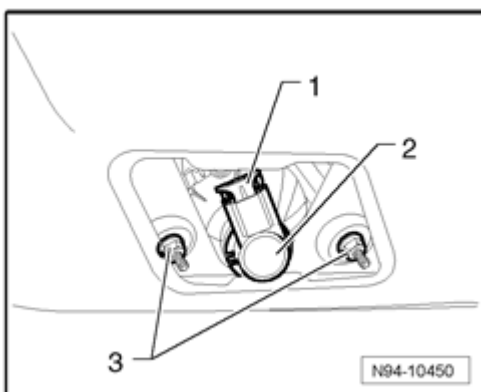

### Installing:

Install in reverse order of removal, noting the following:

- When installing, install upper nuts first, followed by the lower nuts.



- Tighten nuts - **3** - according to value in table ⇒ [94-12, Rear lights in rear lid - Sedan, tightening torques:](#) .
- Reconnect electrical connection to bulb holder so that it engages audibly.
- Check gap dimension to body after installing rear lamp assembly.

#### Rear lights in rear lid - bulb holder, removing and installing

##### Removing:

##### **Caution!**

- **Switch off all electrical consumers.**
- **Switch ignition off and remove ignition key.**

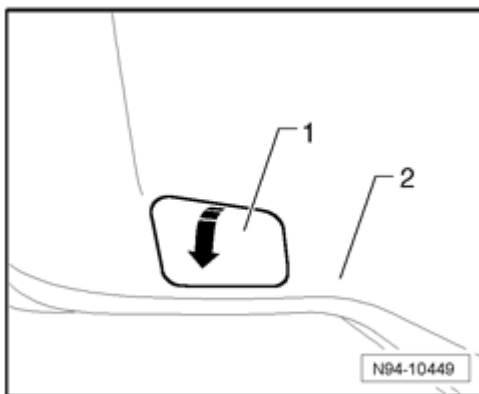

- Unclip cover - **1** - in direction of - **arrow** - from panel - **2**
- .

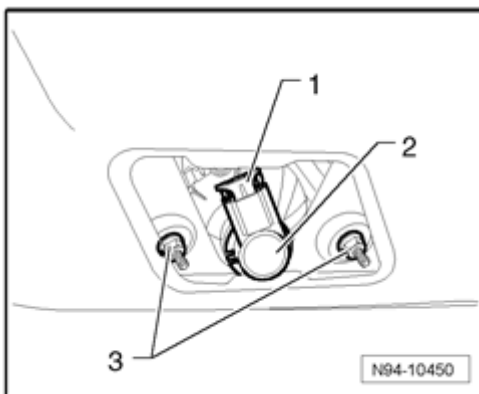

- Disconnect electrical connection - **1** - and remove from bulb holder - **2** - .

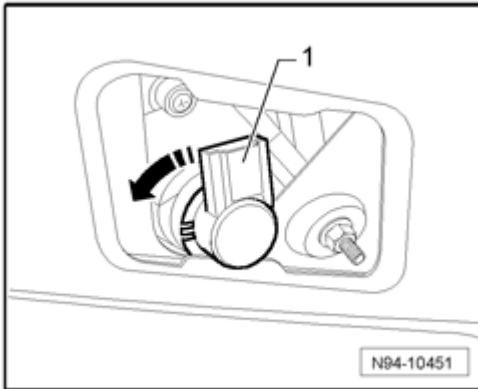

- Turn bulb holder - **1** - in direction of - **arrow** - and remove from rear light housing.

Back-up lamp bulb: 12 V, P 21 W

### **Installing:**

Install in reverse order of removal, noting the following:

- Reconnect electrical connection to bulb holder so that it engages audibly.

### **Rear lights in rear lid, checking**

Left Back-Up Lamp M16 and Right Back-Up Lamp M17 function can be checked using Vehicle Electrical System Control Module J519 On Board Diagnostic (OBD) function "Output Diagnostic Test Mode (DTM)" ⇒ [97-6, Vehicle Electrical System Control Module J519 , Output Diagnostic Test Mode \(DTM\)](#) .

### **Rear lights in rear fenders - Wagon, servicing**

### **Rear lights in rear fenders, component overview**

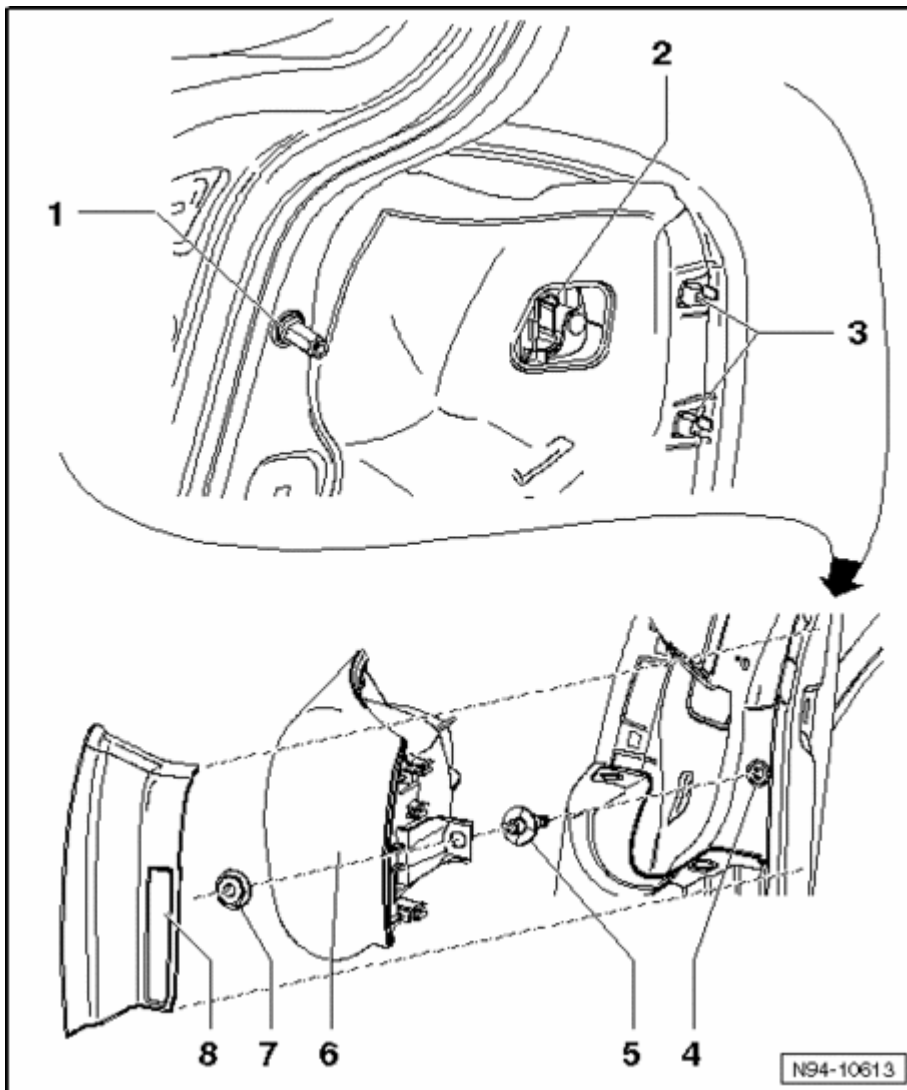

- 1 - Combination screw/adjuster**
- 2 - Rear light electrical connection**
- 3 - Spring retainers**
- 4 - Thread retainer**
  - For mounting screw/adjuster
- 5 - Combination screw/adjuster**
  - For adjusting gaps between rear light and body
- 6 - Rear light in rear fender**
  - Removing and installing ⇒ [94-6, Rear lights in rear fenders, removing and installing](#)
  - Checking ⇒ [94-6, Rear lights in rear fenders, checking](#)

## 7 - Nut

- Tightening torque ⇒ [94-12, Rear lights in rear lid - Sedan, tightening torques:](#)

## 8 - Cover

### Rear lights in rear fenders, removing and installing

Rear light housing in rear fender cannot be dismantled.  
The following components are integrated:

- Left Taillamp M4 and Right Taillamp M2
- Left Brake Lamp M9 and Right Brake Lamp M10
- Left Rear Turn Signal Lamp M6 and Right Rear Turn Signal Lamp M8

### Special tools, testers and auxiliary items required

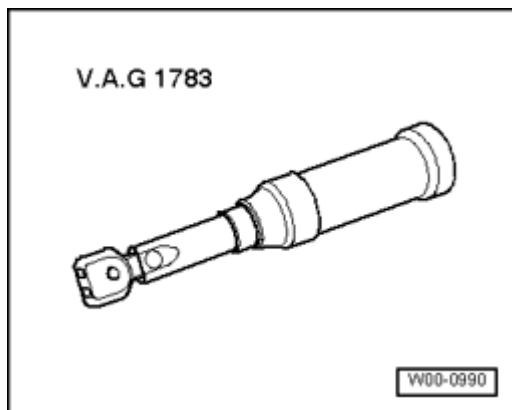

- Torque Wrench (5-60 Nm) VAG 1783 (or equivalent)

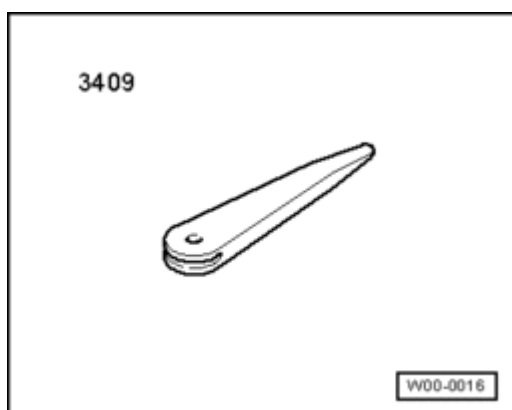

- Trim wedge VAS 3409 (or equivalent)

**Note:**

- *The following illustrations depict removal and installation on right side. Removal and installation on left side is the same.*

**Removing:****Caution!**

- **Switch off all electrical consumers.**
- **Switch ignition off and remove ignition key.**
- **Leave remote control ignition key in passenger compartment in order to prevent accidental door locking and automatic headlamp "Coming home/leaving home" activation.**
- **When removing switches, trim, covers or displays, prevent damage to visible areas by always applying appropriate tape to area surrounding the component, and the tools being used (screwdrivers, wedges etc.).**

- Open rear lid.

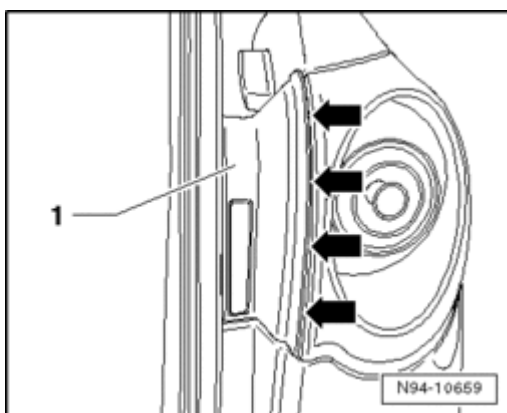

- Unclip and remove cover - **1** - , starting at edge of rear light in direction of - **arrow** - .

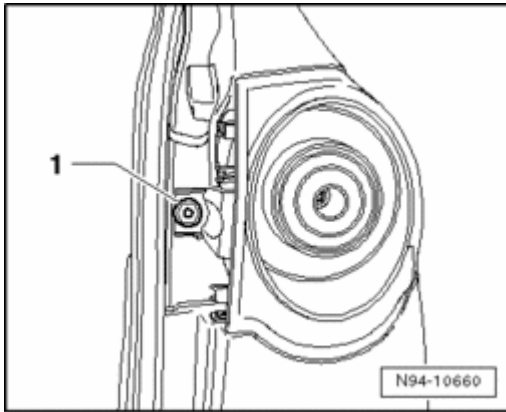

- Remove nut (SW 14) - **1** - .

**Note:**

- *Rear light housing is secured to inner side of fender opening with spring clips.*

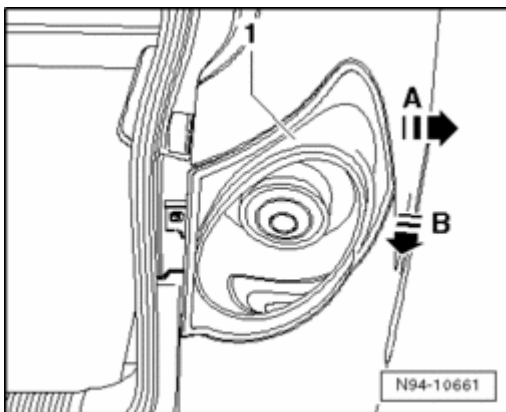

- Release rear light housing from spring clips by first pressing light housing outwards - **arrow A** - . Carefully use Trim removal wedge 3409 to assist with pressing light housing away from body.

- When spring clips are disengaged, pull light housing - **1** - from fender opening towards rear - **arrow B** - as far as attached wiring harness allows.

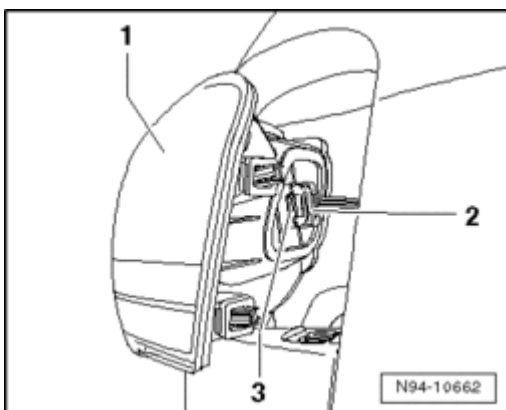

- Release and disconnect electrical connection - **2** - by disengaging retainer - **3** - .
- Remove rear light housing - **1** - from fender opening.

### Installing:

Install in reverse order of removal, noting the following:

### Note:

- *Electrical connection - **2** - must be heard to engage audibly.*
- *Connection is correctly secured when retainer - **3** - is fully engaged.*

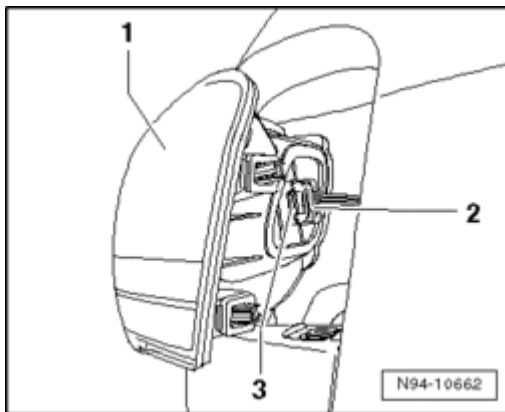

- *Ensure rear light is fully engaged in spring clips (must be heard to engage audibly).*

- Tighten nut at rear light according to value in table ⇒ [94-12, Rear lights in rear fender side panels - Wagon, tightening torques:](#) .

- If necessary, adjust for even gaps between rear light and body using combination screw/adjuster ⇒ [Item - 5 -](#) .

### Rear lights in rear fenders, checking

Left Taillamp M4 , Right Taillamp M2 , Left Brake Lamp M9 , Right Brake Lamp M10 , Left Rear Turn Signal Lamp M6 , Right Rear Turn Signal Lamp M8 function can be checked using Vehicle Electrical System Control Module J519 On Board Diagnostic (OBD) program function "Output Diagnostic Test Mode (DTM)" ⇒ [97-6, Vehicle Electrical System Control Module J519 , Output Diagnostic Test Mode \(DTM\)](#) .

### Rear lights in rear lid - Wagon, servicing

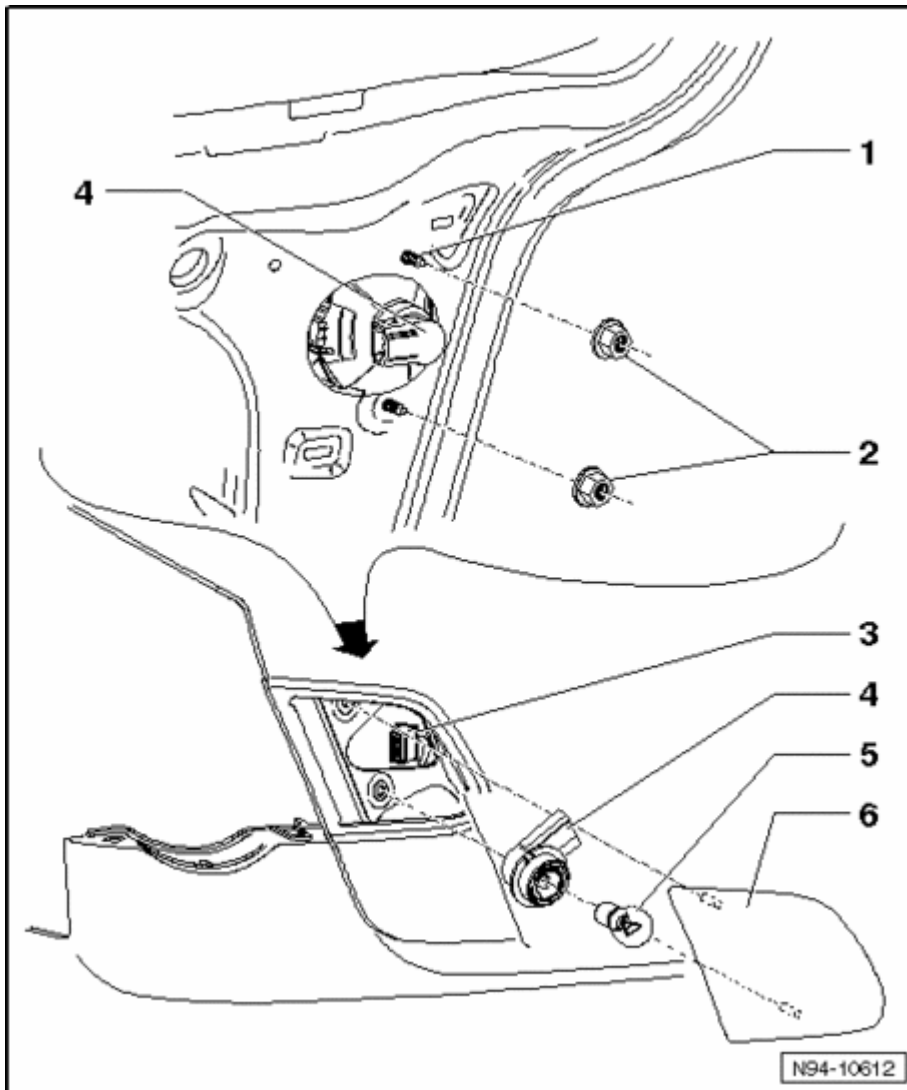
**Rear lights in rear lid, component overview**

**1 - Threaded studs (on rear light housing)**

**2 - Nuts**

- Tightening torque ⇒ [94-12, Rear lights in rear lid - Sedan, tightening torques:](#)

**3 - Electrical connection**

**4 - Bulb holder**

- Removing and installing ⇒ [94-6, Rear lights in rear lid - bulb holder, removing and installing](#)

**5 - Right Back-Up Lamp M17 / Left Back-Up Lamp M16**

- 12 V, P 21 W



- Checking ⇒ [94-6, Rear lights in rear lid, checking](#)

## 6 - Rear light in rear lid

- Removing and installing ⇒ [94-6, Rear light in rear lid, removing and installing](#)

### Rear light in rear lid, removing and installing

#### Special tools, testers and auxiliary items required

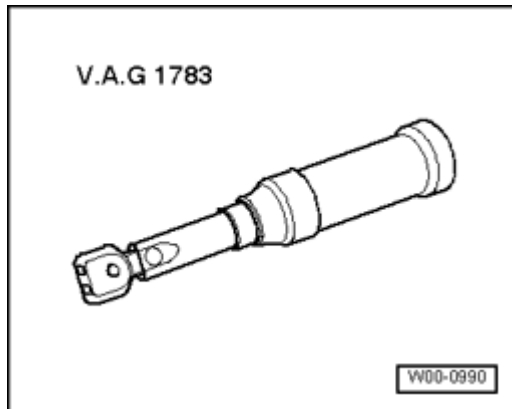

- Torque Wrench (5-60 Nm) VAG 1783 (or equivalent)

#### **Note:**

- *The following illustrations depict removal and installation on left side. Removal and installation on right side is the same.*

#### **Removing:**

##### **Caution!**

- **Switch off all electrical consumers.**
- **Switch ignition off and remove ignition key.**

- Open rear lid.

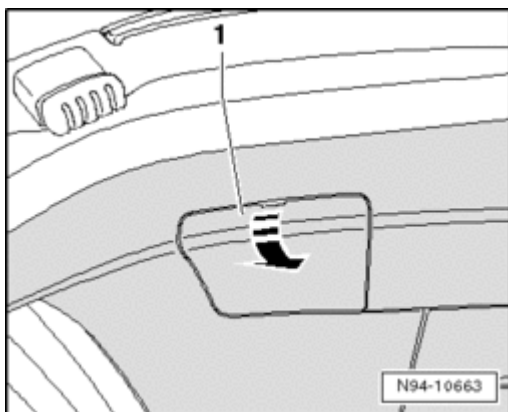

- Unclip access panel - 1 - in direction of - **arrow** - .

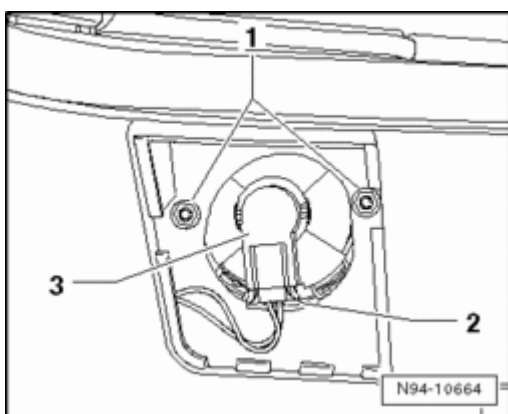

- Disconnect electrical connection - 2 - from bulb holder - 3 - .
- Remove nuts - 1 - .
- Remove rear light housing from rear lid.

### Installing:

Install in reverse order of removal, noting the following:

- When installing, install upper nuts first, followed by the lower nuts.

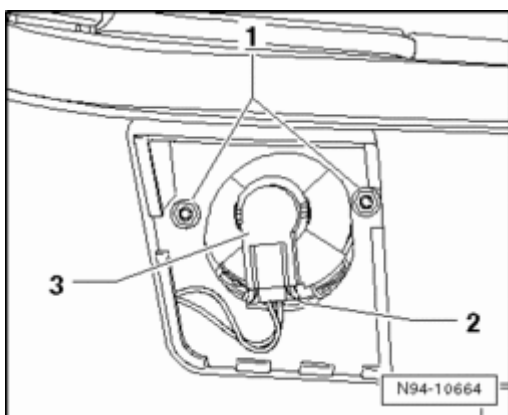

- Tighten nuts - 1 - according to value in table ⇒ [94-12](#).

### Rear lights in rear lid - Wagon, tightening torques: .

- Reconnect electrical connection - **2** - to bulb holder - **3** - so that it engages audibly.
- Check gap dimension to body after installing rear lamp assembly.

### Rear lights in rear lid - bulb holder, removing and installing

#### **Note:**

- *The following illustrations depict removal and installation on left side. Removal and installation on right side is the same.*

#### **Removing:**

#### **Caution!**

- **Switch off all electrical consumers.**
- **Switch ignition off and remove ignition key.**

- Open rear lid.

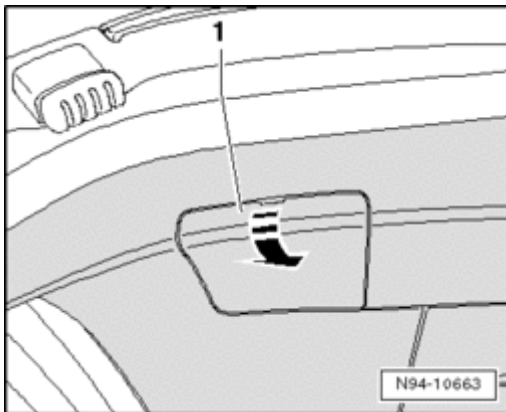

- Unclip access panel - **1** - in direction of - **arrow** - .

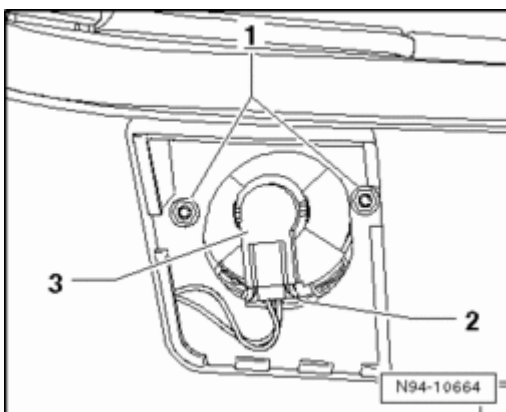

- Disconnect electrical connection - **2** - from bulb holder - **3** - .

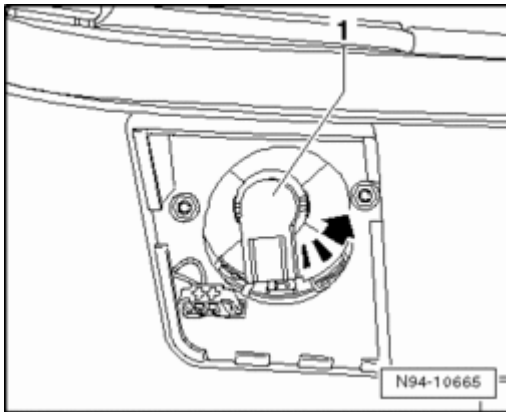

- Turn bulb holder - **1** - counterclockwise - **arrow** - and remove from housing.

Replacement bulb: 12 V, P 21 W

### **Installing:**

Install in reverse order of removal, noting the following:

- Reconnect electrical connection to bulb holder so that it engages audibly.

### **Rear lights in rear lid, checking**

Left Back-Up Lamp M16 and Right Back-Up Lamp M17 function can be checked using Vehicle Electrical System Control Module J519 On Board Diagnostic (OBD) function "Output Diagnostic Test Mode (DTM)" ⇒ [97-6, Vehicle Electrical System Control Module J519 , Output Diagnostic Test Mode \(DTM\)](#) .