



Fog Lamps

General information

Fog lamp function can be checked using Vehicle Electrical System Control Module J519 On Board Diagnostic (OBD) program function "Output Diagnostic Test Mode (DTM)" ⇒ [97-6, Vehicle Electrical System Control Module J519 , Output Diagnostic Test Mode \(DTM\)](#) .

Before troubleshooting or servicing, technicians must be familiar with the functions and operation specifics of the standard or optional headlamp or lighting system. Always read the owners manual and review applicable system functions.

Note:

- *Additional information:*

⇒ *Owners Manual*

⇒ *Self Study Program - Course Number 891503 "The 2006 Passat Introduction"*

⇒ *Self Study Program - Course Number 871503 "The 2006 Passat Electrical Systems Design and Function"*

⇒ *Electrical Wiring Diagrams, Troubleshooting and Component Locations binder*

CAN-Bus wire repairs ⇒ [97-8, Repairing CAN-Bus wires](#)

On Board Diagnostic, function

Vehicle electrical system control is equipped with On Board Diagnostics (OBD) capabilities which assists in troubleshooting fog lamps.

For troubleshooting, use Vehicle Diagnostic, Testing and Information System VAS 5051/5052 in operating mode "Guided Fault Finding" ⇒ [97-1, VAS 5051 / 5052](#) .

Fog lamps, component overview

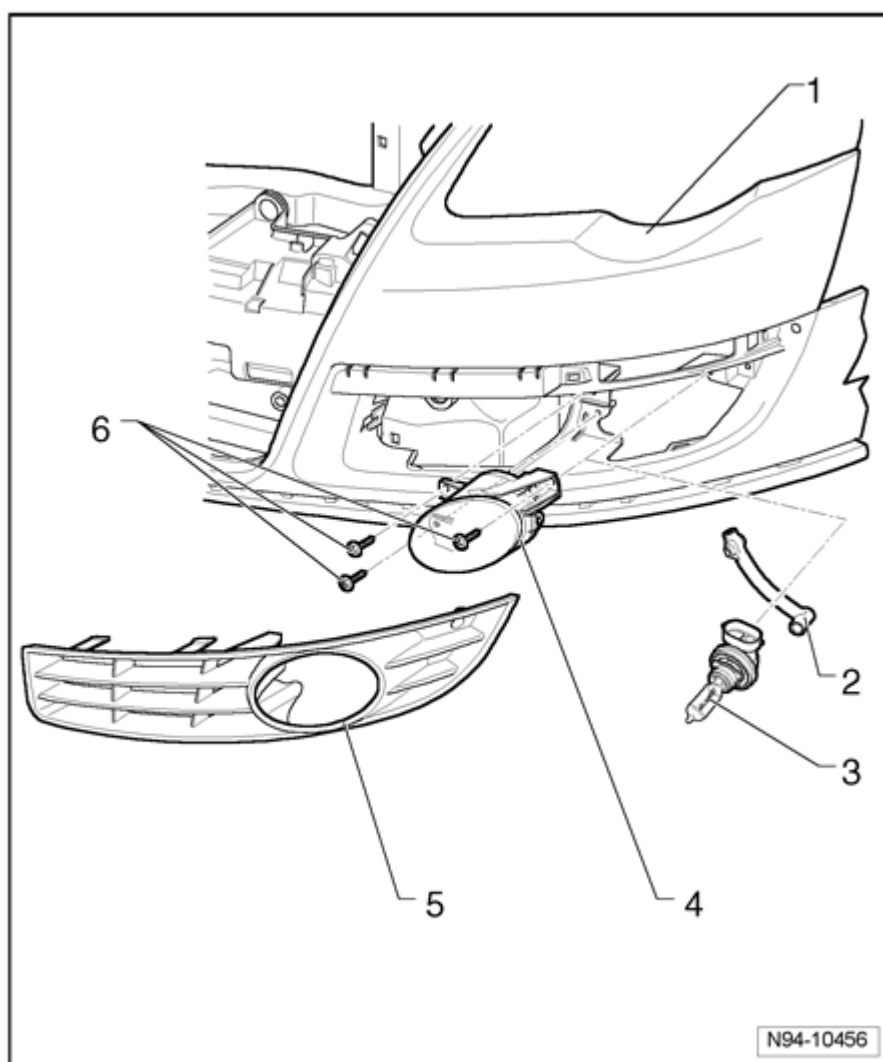

1 - Front bumper

2 - Ventilation hose

3 - Left Front Fog Lamp L22 and Right Front Fog Lamp L23

- Lamp H11 12 V, 55 W
- Removing and installing ⇒ [94-3, Fog lamp bulb L22 / L23, removing and installing](#)
- Checking ⇒ [94-3, Fog lamps, checking](#)

4 - Fog lamp housing

- Removing and installing ⇒ [94-3, Fog lamp, removing and installing](#)

5 - Cover

6 - Screws

- Tightening torque ⇒ [94-12, Fog Lamps, tightening torques](#)

Fog lamp, removing and installing

Note:

- *Illustrations depict removal and installation of left fog light. Procedure for right fog lamp is the same.*

Removing:

Caution!

- **Switch off all electrical consumers.**
- **Switch ignition off and remove ignition key.**

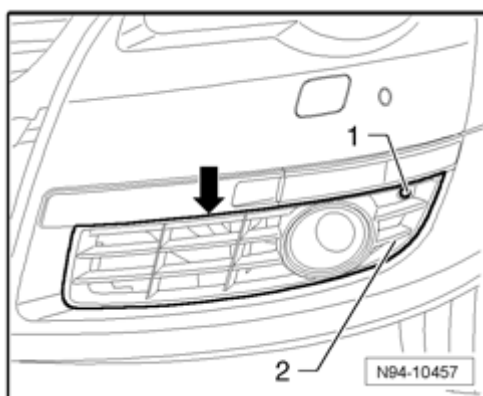

- Remove screws - **1** - and unclip cover - **2** - upwards - **arrow** - out of bumper cover.

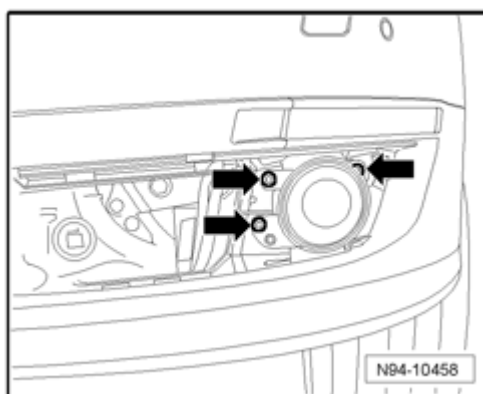

- Remove screws - **arrows** - .

- Remove fog lamp housing from bumper, considering length of attached harness.

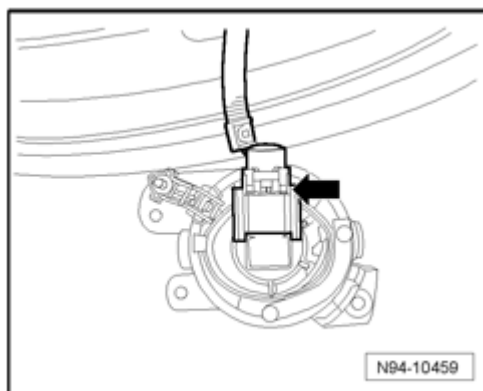

- Release and disconnect electrical connection - **2** - .

Installing:

Install in reverse order of removal, noting the following:

- Torque all fasteners according to value in table ⇒ [94-12, Fog Lamps, tightening torques](#) .
- Perform functional check of fog lamps.
- Check fog light adjustment and adjust if necessary

⇒ *Repair Manual, Maintenance, Repair Group 00,*

.

Fog lamp bulb L22 / L23, removing and installing

Note:

- *The following illustrations depict removal and installation at left fog lamp.*

Removing:

- Remove fog lamp ⇒ [94-3, Fog lamp, removing and installing](#) .

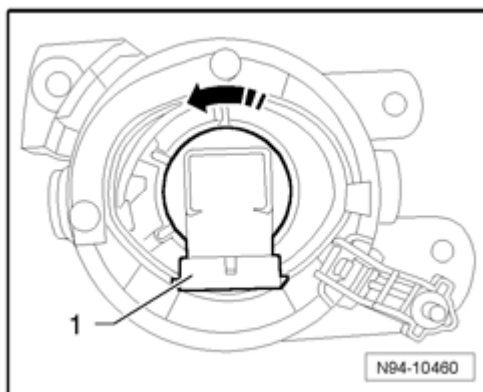

- Rotate socket with bulb in direction of - **arrow** - and remove from fog lamp housing.

The bulb for the fog light is permanently attached to the bulb socket and cannot be replaced separately.

Fog lamp bulb : H11 12 V, 55 W

Installing:

Install in reverse order of removal, noting the following:

Caution!

- ***Do not touch glass portion of bulb with bare hands. Even the smallest amount of moisture and/or contaminants from fingers that evaporates on the bulb during operation can cause the glass to cloud over.***
- ***When installing cap, ensure proper seating. Water intrusion will damage headlamp.***

- Perform functional check of fog lamps.
- Check fog lamps ⇒ [94-3, Fog lamps, checking](#)
- Check fog lamp aim and adjust if necessary ⇒ [94-3, Fog lamps, adjusting](#) .

Fog lamps, checking

Left Front Fog Lamp L22 and Right Front Fog Lamp L23 function can be checked using Vehicle Electrical System Control Module J519 On Board Diagnostic (OBD) program function "Output Diagnostic Test Mode (DTM)" ⇒ [97-6, Vehicle Electrical System Control Module J519 , Output Diagnostic Test Mode \(DTM\)](#) .

Fog lamps, adjusting**Special tools, testers and auxiliary items required**

- Optical Headlight Aimer VAS 5107

Always adjust fog lamps with optical headlamp aimer VAS 5107 using detailed aiming procedure and specifications

⇒ *Repair Manual, Maintenance, Repair Group 00,*

.